

PLAN OF THE FRAME

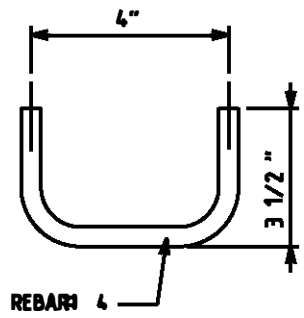
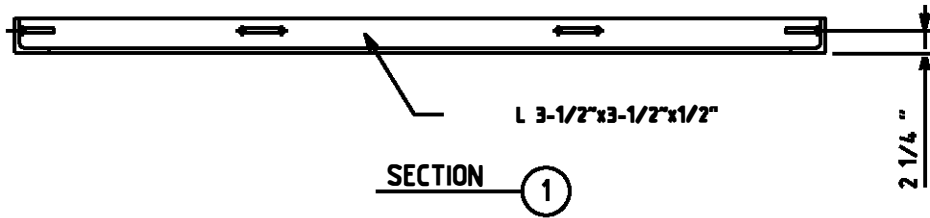

DETAIL A
1" = 5"

FRAME NOTES: SEE PAGE 3

DRAWN: LKD | DVLPED: CEG | DATE: 02-10-82 | REVIEWED: RDS | DATE: 09/02/15 | APPRVD: AAT | DATE: 09/02/15 | NEXT REVIEW: 09/19 | REV: A



POWER
DISTRIBUTION
STANDARDS

3'-6" x 6'-10" FLUSH TYPE ROOF
SLABS FOR SIDEWALK MANHOLES

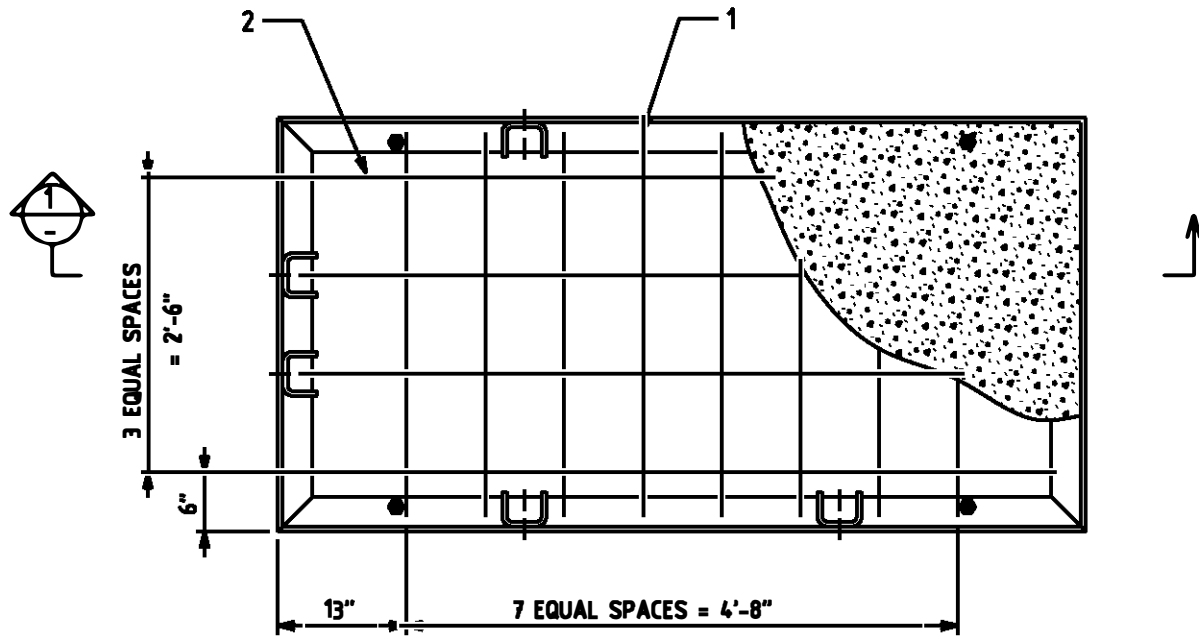

PLAN OF THE SLAB : MHR5735SMY

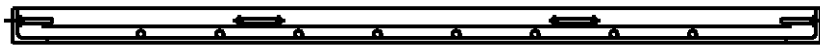

SECTION 1

ROD NO	1	2
QUANTITY	8	4
SIZE	#3	#3
LENGTH	3'-3"	6'-4"

SIDEWALK SLAB NOTES:

- 1: THE REBAR SHALL BE EPOXY AND INSTALLED INTO THE FRAME AS SHOWN.
- 2: CONCRETE SHALL THEN BE TROWL FINISHED FLUSH WITH THE TOP EDGE FRAME.
- 3: SDWK SLAB WEIGHT = 1170 LBS
- 4: 7.0 CU.F.T OF 4000PSI CONCRETE

DRAWN: LKD | DVLPED: CEG | DATE: 02-10-82 | REVIEWED: RDS DATE: 09/02/15 | APPRVD: AAT DATE: 09/02/15 | NEXT REVIEW: 09/19 | REV: A



**POWER
DISTRIBUTION
STANDARDS**

**3'-6" x 6'-10" FLUSH TYPE ROOF
SLABS FOR SIDEWALK MANHOLES**

WELDING SPECIFICATIONS

- 1: ALL STRUCTURAL STEEL SHALL CONFORM TO ASTM A36.
- 2: ALL STEEL IS TO BE WELDED IN ACCORDANCE WITH AWS D1.1 USING EITHER THE SMAW PROCESS (AWS SPEC. A5.1) OR THE FCAW PROCESS (AWS SPEC. A5.20 DR A5.29).
- 3: ALL WELDING IS TO BE PERFORMED ACCORDING TO WELDING PROCEDURE SPECIFICATIONS PFAB200601, PFAB200602 AND PFAB200603.
- 4: ALL WELDERS ARE TO BE QUALIFIED ACCORDING TO AWS D1.1.
- 5: ALL WELDER CERTIFICATION RECORDS ARE TO BE DOCUMENTED, MAINTAINED AND AVAILABLE FOR INSPECTION/VERIFICATION.

DRAWN: LKD | DVLPED: CEG | DATE: 02-10-82 | REVIEWED: RDS DATE: 09/02/15 | APPRVD: AAT DATE: 09/02/15 | NEXT REVIEW: 09/19 | REV: A



POWER
DISTRIBUTION
STANDARDS

3'-6" x 6'-10" FLUSH TYPE ROOF
SLABS FOR SIDEWALK MANHOLES